

Land of  
Amos Williams

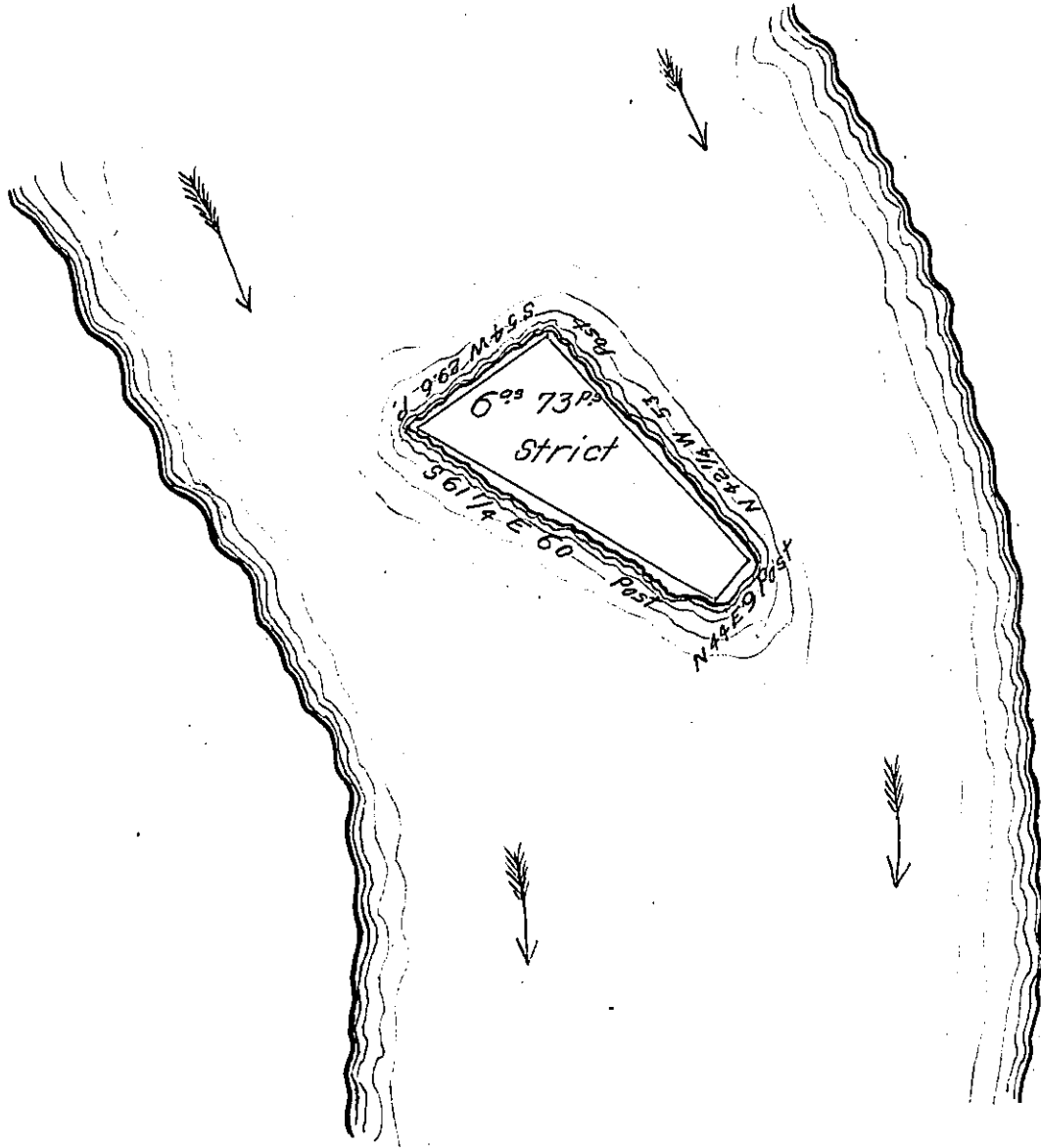

*Draft of an Island situate in the Allegheny River opposite to land of Amos Williams on the South and Known as "Charley's bar."*

*Surveyed August 16<sup>th</sup> 1865 for Matthew L. Whan Esqr. in pursuance of a warrant granted to him dated 10<sup>th</sup> day April A.D. 1865.*

*Hon. J. P. Barr  
Surveyor General.*

*W<sup>m</sup> Hilands  
C.S.*

*IN TESTIMONY that the above is a copy of the original remaining on file in the Department of Internal Affairs of Pennsylvania, made conformably to an Act of Assembly approved the 16th day of February, 1833, I have hereunto set my Hand and caused the Seal of said Department to be affixed at Harrisburg, this Twelfth day of June 1907*

*Henry Howek  
Secretary of Internal Affairs.*